

BUBBLE 80

trimless

xal.com/bubble



Quickinfo

GENERAL

recessed
IP 20, IP 40
plasterboard ceilings only

LED

COB LED module
up to 86lm/W
2700K, 3000K, 4000K, CWD
CRI ≥ 90
Binning initial ≤ 3 MacAdam

ESTIMATED LED LIFETIME

L80 / 50000h

OPTICAL

direct illumination
beam angle 6°, 27°, 37°
optical accessories

ELECTRICAL

non DIM, DIM DALI

PHYSICAL

gypsum housing
aluminium inset
powder-coated

BUBBLE

trimless
[page 176](#)



Description

DE Hyperbolisch geformtes Einbaugehäuse aus Gips (überstreichbar); für randlosen Einbau in Gipskartondecken; abgerundete Innenkontur; geeignet für Deckenstärken von 10-25 mm; ruhiges Deckenbild durch zurückversetzte Leuchtebene; ein Strahler (SASSO) werkzeuglos einsetzbar durch Kugelschnappsystem; 360° dreh- und 35° schwenkbar; Oberfläche weiß, silbergrau oder schwarz pulverbeschichtet; optische Aufsätze sind als Zubehör erhältlich; passive Kühlung der LEDs durch optimierte Kühlkörpergeometrie; COB (Chip on Board) Technologie für höchste Effizienz; keine Bildung von Mehrfachschatten; energieeffiziente LEDs mit sehr guter Farbwiedergabe; Binning initial ≤ 3 MacAdam; lieferbar in den Lichtfarben 2700K, 3000K und 4000K; optional mit CWD (Colour Warm Dimming); CRI ≥ 90; min. 80% des Lichtstromes nach 50000h Lebensdauer; hochwertiger Reflektor mit sphärischer Facettenoptik; präzise Abstrahlcharakteristik mit drei verschiedenen Ausstrahlwinkeln; werkzeuglos einsetz- bzw. austauschbar; Schutzart IP 20 oder IP 44; SK II; optional DALI-dimmbar

EN Hyperbolic shaped installation housing made of plaster (paintable); for trimless installation in plasterboard ceilings; rounded internal contour; suitable for ceiling thickness of 10-25 mm; uncluttered ceiling look through recessed lighting level; one spotlight (SASSO), installation with ball catch system, without tools; 360° rotatable and 35° tiltable; surface white, silver-grey or black powder coated; optical attachments available as accessories; passive cooling of LEDs with optimised heat sink geometry; COB (Chip on Board) technology for maximum efficiency; no multiple shadows; energy-efficient LEDs with very good colour rendering; binning initial ≤ 3 MacAdam; available in the light colours 2700K, 3000K and 4000K; optional with CWD (Colour Warm Dimming); CRI ≥ 90; min. 80% of the luminous flux after 50000 hours; high quality reflector with spherical facet finish; precise radiation characteristic with three different beam angles; installed and exchanged without tools; protection class IP 20 or IP 44; PC II; optional DALI dimmable

Features



exchangeable light engine



patented ball catch system



skimmed into plasterboard ceiling (trimless)

Standard configuration

COLOUR TEMPERATURE ◆◆
3000K 5

CONTROL ◆
non DIM 1

MATERIAL COLOUR ■
white 7

7

REFLECTOR ▲
flood 37° F

Extended configuration

COLOUR TEMPERATURE ◆◆
2700K 4
4000K 6

CONTROL ◆
DIM DALI 3

MATERIAL COLOUR ■
silver-grey G
black 8

G 8

+5% surcharges

REFLECTOR ▲
medium 27° M

LENS ▲
super spot 6° (only 8W non DIM) V

Options on request

CONTROL
phase-cut DIM

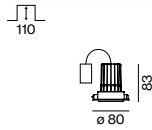

INSET SASSO 80 flush



SYS. POWER	COLOUR TEMP.	LUMINOUS FLUX	ORDER CODE	
8 W	2700K	630lm	0 4 8 - 2 3 1 0 ◆ ▲	
	3000K	660lm		
	4000K	700lm		
10 W CWD	1800-3000K (CRI ≥ 95)		0 4 8 - 2 3 1 0 0 3 ■ M	
	12 W	2700K	950lm	0 4 8 - 2 3 1 2 ◆ ▲
		3000K	980lm	
12 W IP 44	4000K	1050lm		
	3000K	980lm	8 4 8 - 2 3 1 2 5 ◆ F	

LIGHT DISTRIBUTION for 12W, 3000K

super spot 6° (8W)			medium 27°			flood 37°		
h (m)	E (lx)	ø (m)	h (m)	E (lx)	ø (m)	h (m)	E (lx)	ø (m)
1	21750	ø0,11	1	2534	ø0,48	1	1826	ø0,68
2	5437	ø0,21	2	633	ø0,96	2	456	ø1,36
3	2416	ø0,32	3	281	ø1,44	3	202	ø2,03
4	1359	ø0,43	4	158	ø1,92	4	114	ø2,71
5	870	ø0,53	5	101	ø2,40	5	73	ø3,39

Optical accessories

TYPE	ORDER CODE
honeycomb louver	0 4 8 - 2 0 9 1 3 1 ■
linear prismatic lens	0 4 8 - 2 0 9 2 3 1 ■
snoot	0 4 8 - 2 0 9 1 1 1 ■
snoot with honeycomb louver	0 4 8 - 2 0 9 1 2 1 ■

use only 1 optical accessory

Mounting accessories

BUBBLE 80

TRIMLESS MOUNTING HOUSING 80
for installation in plasterboard ceilings 10-25mm

TYPE	ORDER CODE
1 lamp	0 6 0 - 0 2 8 1 7

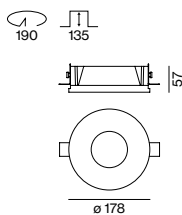

Inspiration

Eggersmann Showroom
Hiddenhausen, Germany

ARCHITECT
BKS Architekten
Lübbecke, Germany

PRODUCT
BUBBLE 80 trimless





BUBBLE 100

trimless

xal.com/bubble



Quickinfo

GENERAL

recessed
IP 20, IP 44
plasterboard ceilings only

LED

COB LED module
up to 93lm/W
2700K, 3000K, 4000K, CWD
CRI ≥ 90
Binning initial ≤ 3 MacAdam

ESTIMATED LED LIFETIME

L80 / 50000h

OPTICAL

direct illumination
beam angle 18°, 24°, 36°
optical accessories

ELECTRICAL

non DIM, DIM DALI

PHYSICAL

gypsum housing
aluminium inset
powder-coated

BUBBLE

trimless
[page 176](#)



Description

DE Hyperbolisch geformtes Einbaugehäuse aus Gips (überstreichbar); für randlosen Einbau in Gipskartondecken; abgerundete Innenkontur; geeignet für Deckenstärken von 10-25 mm; ruhiges Deckenbild durch zurückversetzte Leuchtebene; ein Strahler (SASSO) werkzeuglos einsetzbar durch Kugelschnappsystem; 360° dreh- und 35° schwenkbar; Oberfläche weiß, silbergrau oder schwarz pulverbeschichtet; optische Aufsätze sind als Zubehör erhältlich; passive Kühlung der LEDs durch optimierte Kühlkörpergeometrie; COB (Chip on Board) Technologie für höchste Effizienz; keine Bildung von Mehrfachschatten; energieeffiziente LEDs mit sehr guter Farbwiedergabe; Binning initial ≤ 3 MacAdam; lieferbar in den Lichtfarben 2700K, 3000K und 4000K; optional mit CWD (Colour Warm Dimming); CRI ≥ 90; min. 80% des Lichtstromes nach 50000h Lebensdauer; hochwertiger Reflektor mit sphärischer Facettenoptik; präzise Abstrahlcharakteristik mit drei verschiedenen Ausstrahlwinkeln; werkzeuglos einsetz- bzw. austauschbar; Schutzart IP 20 oder IP 44; SK II; optional DALI-dimmbar

EN Hyperbolic shaped installation housing made of plaster (paintable); for trimless installation in plasterboard ceilings; rounded internal contour; suitable for ceiling thickness of 10-25 mm; uncluttered ceiling look through recessed lighting level; one spotlight (SASSO), installation with ball catch system, without tools; 360° rotatable and 35° tiltable; surface white, silver-grey or black powder coated; optical attachments available as accessories; passive cooling of LEDs with optimised heat sink geometry; COB (Chip on Board) technology for maximum efficiency; no multiple shadows; energy-efficient LEDs with very good colour rendering; binning initial ≤ 3 MacAdam; available in the light colours 2700K, 3000K and 4000K; optional with CWD (Colour Warm Dimming); CRI ≥ 90; min. 80% of the luminous flux after 50000 hours; high quality reflector with spherical facet finish; precise radiation characteristic with three different beam angles; installed and exchanged without tools; protection class IP 20 or IP 44; PC II; optional DALI dimmable

Features



exchangeable light engine



patented ball catch system



skimmed into plasterboard ceiling (trimless)

Standard configuration

COLOUR TEMPERATURE ◆◆
3000 K 5

CONTROL ◆
non DIM 1

MATERIAL COLOUR ■
white 7

7

REFLECTOR ▲
flood 36° F

Extended configuration

COLOUR TEMPERATURE ◆◆
2700 K 4
4000 K 6

CONTROL ◆
DIM DALI 3

MATERIAL COLOUR ■
silver-grey G
black 8

G

8

+5% surcharges

REFLECTOR ▲
spot 18° S
medium 24° M

Options on request

CONTROL
phase-cut DIM

LENS
beam angle 14°, 24°

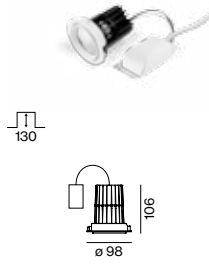

INSET SASSO 100 flush



SYS. POWER	COLOUR TEMP.	LUMINOUS FLUX	ORDER CODE
13 W	2700 K	1170 lm	0 4 8 - 2 4 1 0 ◆◆ ▲
18 W CWD	3000 K	1210 lm	0 4 8 - 2 4 1 1 0 3 ■ ▲
27 W	1800–3000 K (CRI ≥ 95)	900 lm	0 4 8 - 2 4 1 2 ◆◆ ▲
	2700 K	2110 lm	
	3000 K	2190 lm	
	4000 K	2340 lm	
27 W IP 44	3000 K	2190 lm	8 4 8 - 2 4 1 2 5 ◆ 7 F

LIGHT DISTRIBUTION for 27 W, 3000 K

spot 18°			medium 24°			flood 36°		
h (m)	E (lx)	ø (m)	h (m)	E (lx)	ø (m)	h (m)	E (lx)	ø (m)
1	14162	ø0,31	1	9171	ø0,42	1	5376	ø0,65
2	3540	ø0,62	2	2292	ø0,84	2	1344	ø1,31
3	1573	ø0,93	3	1019	ø1,27	3	597	ø1,96
4	885	ø1,24	4	573	ø1,69	4	336	ø2,61
5	566	ø1,55	5	366	ø2,11	5	215	ø3,27

Optical accessories

TYPE	ORDER CODE
honeycomb louver	0 4 8 - 2 1 9 1 3 1 ■
linear prismatic lens	0 4 8 - 2 1 9 2 3 1 ■
snoot	0 4 8 - 2 1 9 1 1 1 ■
snoot with honeycomb louver	0 4 8 - 2 1 9 1 2 1 ■

use only 1 optical accessory

Mounting accessories

BUBBLE 100

TRIMLESS MOUNTING HOUSING 100
for installation in plasterboard ceilings 10–25 mm

TYPE	ORDER CODE
1 lamp	0 6 0 - 0 2 9 2 7

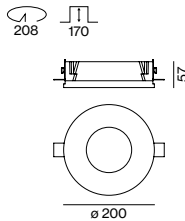

Inspiration

Nestlé Super Premium,
Mövenpick Ice Cream Gallery
Zurich, Switzerland

ARCHITECT

Concept Consult Design Sàrl
Lausanne, Switzerland

LIGHTING DESIGN

Aebischer et Bovigny
Lausanne, Switzerland

PRODUCT

BUBBLE 100 trimless





BUBBLE 150

trimless

xal.com/bubble



Quickinfo

GENERAL

recessed
IP20
plasterboard ceilings only

LED

COB LED module
up to 101lm/W
3000K, 4000K
CRI ≥ 90
Binning initial ≤ 3 MacAdam

ESTIMATED LED LIFETIME

L80 / 50000h

OPTICAL

direct illumination
beam angle 14°, 25°, 41°
optical accessories

ELECTRICAL

non DIM, DIM DALI

PHYSICAL

gypsum housing
aluminium inset
powder-coated

BUBBLE

trimless
page 176



Description

DE Hyperbolisch geformtes Einbaugehäuse aus Gips (überstreichbar); für randlosen Einbau in Gipskartondecken; abgerundete Innenkontur; geeignet für Deckenstärken von 10-25 mm; ruhiges Deckenbild durch zurückversetzte Leuchtebene; ein Strahler (SASSO) werkzeuglos einsetzbar durch Kugelschnappsystem; 360° dreh- und 35° schwenkbar; Oberfläche weiß, silbergrau oder schwarz pulverbeschichtet; optische Aufsätze sind als Zubehör erhältlich; passive Kühlung der LEDs durch optimierte Kühlkörpergeometrie; COB (Chip on Board) Technologie für höchste Effizienz; keine Bildung von Mehrfachschatten; energieeffiziente LEDs mit sehr guter Farbwiedergabe; Binning initial ≤ 3 MacAdam; lieferbar in den Lichtfarben 3000K und 4000K; CRI ≥ 90; min. 80% des Lichtstromes nach 50000h Lebensdauer; hochwertiger Aluminiumreflektor mit sphärischer Facettenoptik; hochglänzend eloxiert; präzise Abstrahlcharakteristik mit drei verschiedenen Ausstrahlwinkeln; werkzeuglos einsetz- bzw. austauschbar; Schutzart IP20; SK II; optional DALI-dimmbar

EN Hyperbolic shaped installation housing made of plaster (paintable); for trimless installation in plasterboard ceilings; rounded internal contour; suitable for ceiling thickness of 10-25 mm; uncluttered ceiling look through recessed lighting level; one spotlight (SASSO), installation with ball catch system, without tools; 360° rotatable and 35° tiltable; surface white, silver-grey or black powder coated; optical attachments available as accessories; passive cooling of LEDs with optimised heat sink geometry; COB (Chip on Board) technology for maximum efficiency; no multiple shadows; energy-efficient LEDs with very good colour rendering; binning initial ≤ 3 MacAdam; available in the light colours 3000K and 4000K; CRI ≥ 90; min. 80% of the luminous flux after 50000 hours; high quality aluminium reflector with spherical facet finish; high gloss anodised; precise radiation characteristic with three different beam angles; installed and exchanged without tools; protection class IP20; PC II; optional DALI dimmable

Features



exchangeable light engine



patented ball catch system



skimmed into plasterboard ceiling (trimless)

Standard configuration

COLOUR RENDERING INDEX

CRI ≥ 90 5

COLOUR TEMPERATURE ☼☼
3000K 5

CONTROL ⬇️
non DIM 1

MATERIAL COLOUR ☑️
white 7

7

REFLECTOR ▲
flood 41° F

Extended configuration

COLOUR TEMPERATURE ☼☼☼
4000K 6

CONTROL ⬇️
DIM DALI 3

MATERIAL COLOUR ☑️
silver-grey G
black 8

G

8
+5% surcharges

REFLECTOR ▲
spot 14° S
medium 25° M

Options on request

SPECIAL COLOUR

vogue	CRI ≥ 90
gallery	CRI 98
gourmet	CRI ≥ 80
fresh meat & fish	CRI ≥ 80
pastry	CRI ≥ 80
brilliant white	CRI ≥ 90

REFLECTOR
wide flood 58°

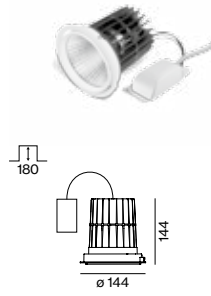

INSET SASSO 150 flush



SYSTEM POWER	COLOUR TEMP.	LUMINOUS FLUX	ORDER CODE
28 W	3000 K	2670 lm	0 4 8 - 2 5 1 0 ☼☼☼▲
44 W	3000 K	3590 lm	0 4 8 - 2 5 1 1 ☼☼☼▲
	4000 K	2860 lm	
	4000 K	3850 lm	

LIGHT DISTRIBUTION for 44 W, 3000 K

spot 14°			medium 25°			flood 41°		
h (m)	E (lx)	ø (m)	h (m)	E (lx)	ø (m)	h (m)	E (lx)	ø (m)
1	32065	ø0,24	1	14573	ø0,44	1	6431	ø0,74
2	8016	ø0,49	2	3643	ø0,87	2	1607	ø1,48
3	3562	ø0,73	3	1619	ø1,31	3	714	ø2,22
4	2004	ø0,97	4	910	ø1,75	4	401	ø2,96
5	1282	ø1,21	5	582	ø2,18	5	257	ø3,70

Optical accessories

TYPE	ORDER CODE
honeycomb louver	0 4 8 - 2 2 9 1 3 1 ☑️
linear prismatic lens	0 4 8 - 2 2 9 2 3 1 ☑️
snoot	0 4 8 - 2 2 9 1 1 1 ☑️
snoot with honeycomb louver	0 4 8 - 2 2 9 1 2 1 ☑️

use only 1 optical accessory

Mounting accessories

BUBBLE 150

TRIMLESS MOUNTING HOUSING 150
for installation in plasterboard ceilings 10–25 mm

TYPE	ORDER CODE
1 lamp	0 6 0 - 0 3 0 1 7

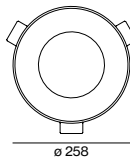
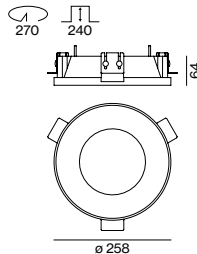

Inspiration

Pharmacy Rondell
Munich, Germany

ARCHITECT
reginadahmeningenhoven
Düsseldorf, Germany

LIGHTING DESIGN
Tropp Lighting Design
Weilheim, Germany

PRODUCT
BUBBLE trimless



