Neox

Light at work

Office sustainable, efficient and ergonomic light, thanks to LED or fluorescent last generation sources.

Available in two different options, floor or suspension, that one in two versions: diffuser flush or set back.

The large opal diffuser surface allows a homogenous light diffusion, antiglare maintaining complaint lighting levels.

Contemporary design shapes, finishes and materials, easily to fit in every operative space.

- + **auto dimmable**
- + **presence sensor**

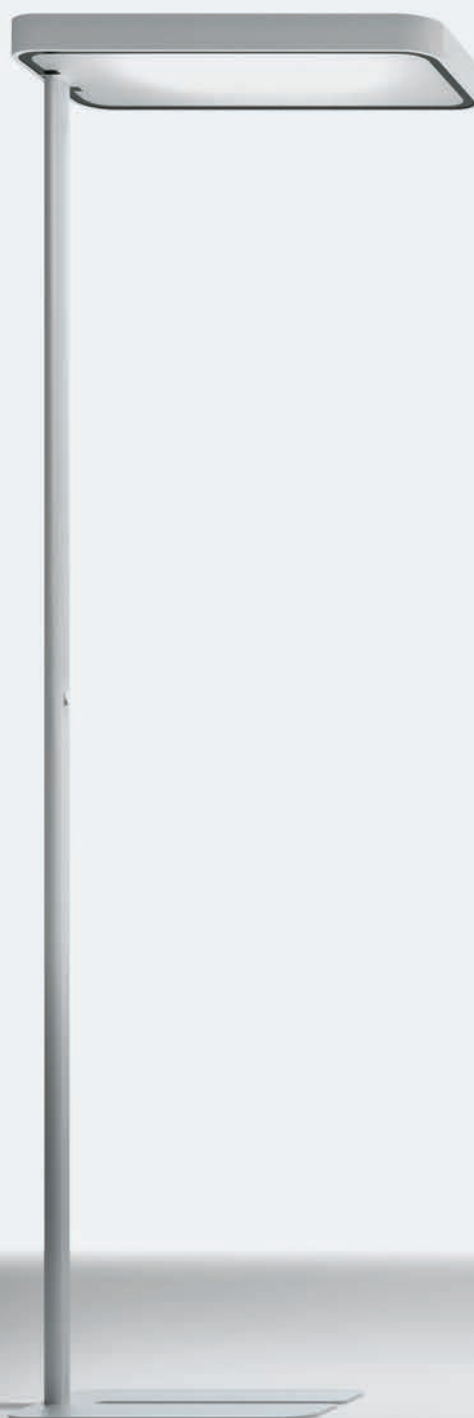

Neox_P | Pendant Luminaires | 198-264 V | topLED 51 W 1400 mA

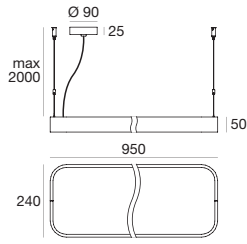

type

White	CRI 80	61814
Grey	CRI 80	61815

colour

4000 K	8209 lm	N
--------	---------	----------

optics

diffused	00
----------	-----------



Neox_FL | Free Standing | 99-264 V | topLED 45 W 1050 mA

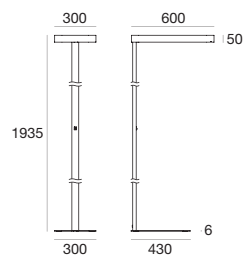
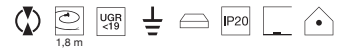

type

White	CRI 80	61834
Grey	CRI 80	61835

colour

4000 K	5720 lm	N
--------	---------	----------

optics

diffused	00
----------	-----------



Neox_FL | Free Standing | 110-240 V | topLED 45 W 1050 mA

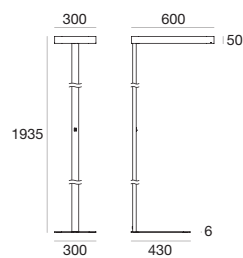
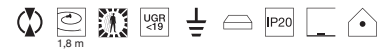

type

White	CRI 80	61824
Grey	CRI 80	61825

colour

4000 K	5720 lm	N
--------	---------	----------

optics

diffused	00
----------	-----------



Motion sensor included

